

DO NOT SCALE
A1

File: CP1770-ATK-01-ZZ-M2-CE-0551.dwg
Date: Jul 05, 2019 - 4:19pm
Plotted by: ENicMhurchu

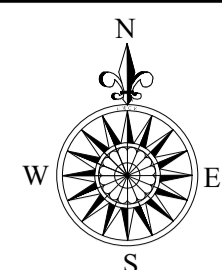
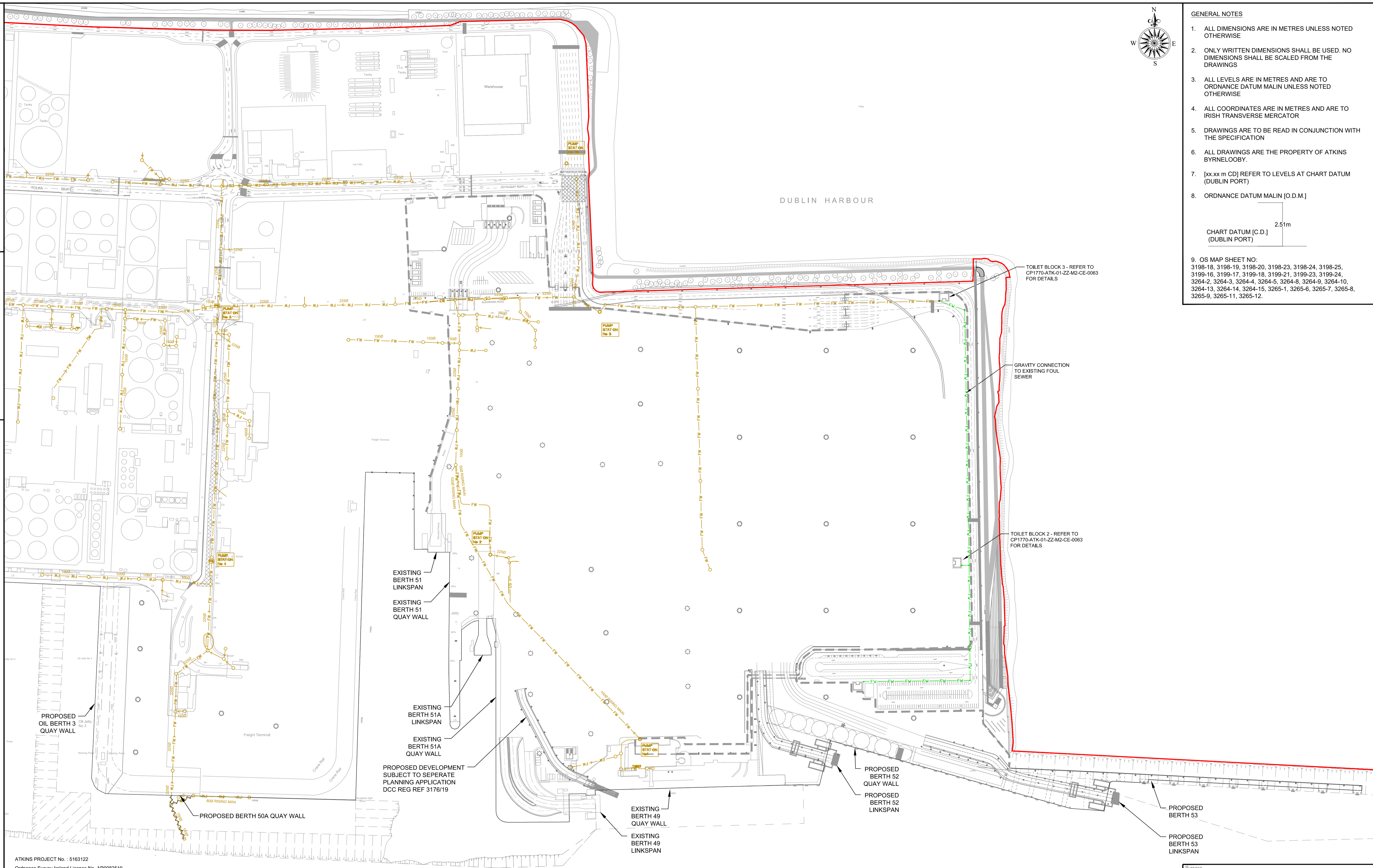

- GENERAL NOTES**
1. ALL DIMENSIONS ARE IN METRES UNLESS NOTED OTHERWISE
 2. ONLY WRITTEN DIMENSIONS SHALL BE USED. NO DIMENSIONS SHALL BE SCALED FROM THE DRAWINGS
 3. ALL LEVELS ARE IN METRES AND ARE TO ORDNANCE DATUM MALIN UNLESS NOTED OTHERWISE
 4. ALL COORDINATES ARE IN METRES AND ARE TO IRISH TRANSVERSE MERCATOR
 5. DRAWINGS ARE TO BE READ IN CONJUNCTION WITH THE SPECIFICATION
 6. ALL DRAWINGS ARE THE PROPERTY OF ATKINS BYRNELOOBY.
 7. [xx.xx m CD] REFER TO LEVELS AT CHART DATUM (DUBLIN PORT)
 8. ORDNANCE DATUM MALIN [O.D.M.]
- CHART DATUM [C.D.] (DUBLIN PORT) 2.51m
9. OS MAP SHEET NO:
3198-18, 3198-19, 3198-20, 3198-23, 3198-24, 3198-25, 3199-16, 3199-17, 3199-18, 3199-21, 3199-23, 3199-24, 3264-2, 3264-3, 3264-4, 3264-5, 3264-8, 3264-9, 3264-10, 3264-13, 3264-14, 3264-15, 3265-1, 3265-6, 3265-7, 3265-8, 3265-9, 3265-11, 3265-12.

ATKINS PROJECT No. : 5163122
Ordnance Survey Ireland Licence No. AR0082519
© Ordnance Survey Ireland/Government of Ireland

- LEGEND:**
- Application Boundary
 - Existing Foul Sewer
 - Existing Combined Sewer
 - Proposed Gravity Foul Sewer
 - Existing Foul Sewer to be Removed
 - Unified Ferry Terminal - International Ship & Port Facility Security (ISPS) Fence Line

00	INTERIM ISSUE NO. 3	MOD	07.19	KH	AC
Rev	Description	By	Date	Chk'd	Auth

ATKINS
Member of the SNC-Lavalin Group
BYRNELOOBY
WS Atkins Ireland Ltd. & ByrneLooby Partners Ltd.
Atkins House,
150 Airside Business Park,
Swords, Co. Dublin

Client
**COMHLACHT CHALAFOR
ÁTHA CLIATH
DUBLIN PORT COMPANY**

Project
MP2

Purpose	PLANNING				
Title	PROPOSED FOUL DRAINAGE				
Original Scale	1:2000 @ A1	Design/Drawn	MOD	Checked	KH
Date	05.07.19	Date	05.07.19	Date	05.07.19
Authorised	AC	Authorised	AC	Authorised	AC
Status	P	Drawing Number	CP1770-ATK-01-ZZ-M2-CE-0551	Rev	00